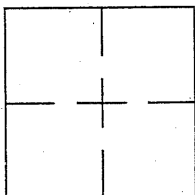

## CORNER RECORD

Document Number CR 5903City of BERKELEYCounty of ALAMEDA, CaliforniaBrief Legal Description BRASS DISC CITY MONUMENT LOCATED WITHIN SAN LUIS ROAD.  
(CITY OF BERKELEY: B1561)

## CORNER RECORD

Government Corner ☐ Control ☒  
 Meander ☐ Property ☐  
 Rancho ☐ Other ☐  
 Date of Survey 10/16/13

COORDINATES  
(Optional)

N. \_\_\_\_\_  
 E. \_\_\_\_\_  
 Zone \_\_\_\_\_ Datum \_\_\_\_\_  
 Elev. \_\_\_\_\_

Corner — Left as found ☒ Found and tagged ☐ Established ☐ Reestablished ☐ Rebuilt ☐

Identification and type of corner found: Evidence used to identify or procedure used to establish or reestablish the corner:  
FOUND BRASS DISC CITY MONUMENT LOCATED WITHIN SAN LUIS ROAD.

(REFERENCE ADDRESS: 797)

THIS POINT WAS REFERENCED PRIOR TO A CONSTRUCTION PROJECT IN THE VICINITY.

A description of the physical condition of the monument as found and as set or reset:  
FOUND AND SET POINTS AS SHOWN ON PAGE 2.

THESE TIES ARE FOR THE PURPOSE OF PERPETUATING THE FOUND MONUMENTATION.

NO CLAIM IS MADE AS TO THE RELATIONSHIP OF THE POINTS OR LINES SHOWN HEREON  
TO TRUE BOUNDARY LOCATIONS.

## SURVEYOR'S STATEMENT

This Corner Record was prepared by me or under my direction in conformance with  
 the Land Surveyors' Act on OCTOBER 18, 2013.

Signed VINCENT H. CUNHA L.S. Number LS 4520



## COUNTY SURVEYOR'S STATEMENT

This Corner Record was received 10-21-2013 and examined  
 and filed 11-24-2013.

Signed Russell R. Penland Title County Surveyor

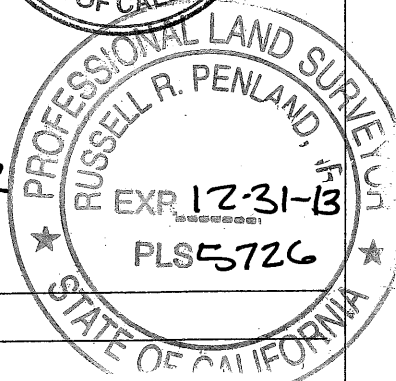

County Surveyor's Comment \_\_\_\_\_

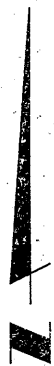

SCALE: 1"=10'

## LEGEND

- FOUND BRASS DISC CITY MONUMENT
- X SET CUT CROSS IN CONCRETE
- C.O.B. CITY OF BERKELEY

## NOTE

ELEVATIONS SHOWN HEREON BASED UPON  
CITY OF BERKELEY VERTICAL DATUM.  
C.O.B. B1561 TAKEN AS EL=506.49

