

PARCEL MAP

OWNER'S STATEMENT:

THE UNDERSIGNED, ASHBY LOFTS ASSOCIATES, A LIMITED PARTNERSHIP, HEREBY STATE THAT IT IS THE OWNER OF SAID LAND DELINEATED AND EMBRACED WITHIN THE EXTERIOR BOUNDARY LINES OF THE HEREIN EMBODIED MAP ENTITLED "PARCEL MAP 8179, CITY OF BERKELEY, COUNTY OF ALAMEDA, CALIFORNIA"; THAT IT IS THE OWNER OF SAID LAND BY VIRTUE OF THE CORPORATION GRANT DEED RECORDED JUNE 30, 2004, UNDER RECORDER'S SERIAL NO. 2004-298050, OFFICIAL RECORDS OF COUNTY OF ALAMEDA, CALIFORNIA; AND IT CONSENTS TO THE PREPARATION AND FILING OF THIS MAP.

THAT SAID OWNER FURTHER CONSENTS TO THE VACATION OF A PORTION OF THE ROADWAY EASEMENT AFFECTING THAT PORTION OF SAID LAND, DESIGNATED "ROADWAY EASEMENT TO BE VACATED" FOR ROADWAY AND HIGHWAY PURPOSE.

ASHBY LOFTS ASSOCIATES, A LIMITED PARTNERSHIP

BY: Susan Friedland
SUSAN FRIEDLAND
EXECUTIVE DIRECTOR

OWNER'S ACKNOWLEDGEMENT:

STATE OF CALIFORNIA }
COUNTY OF ALAMEDA }

ON July 12, 2005 BEFORE ME, Sara Abramowitz-Hill A NOTARY PUBLIC IN AND FOR SAID COUNTY AND STATE, PERSONALLY APPEARED Susan Friedland KNOWN TO ME (OR PROVED TO ME ON THE BASIS OF SUFFICIENT EVIDENCE) TO BE THE PERSON WHOSE NAME IS SUBSCRIBED TO THE WITHIN INSTRUMENT, AND ACKNOWLEDGED TO ME THAT SHE EXECUTED THE SAME IN HER AUTHORIZED CAPACITY AND THAT BY HER SIGNATURE ON THE INSTRUMENT THE PERSON, OR ENTITY UPON BEHALF OF WHICH THE PERSON ACTED, EXECUTED THE INSTRUMENT.

WITNESS MY HAND AND OFFICIAL SEAL

NOTARY PUBLIC IN AND FOR
SAID COUNTY AND STATE OF CALIFORNIA
MY COMMISSION EXPIRES: Sept 29, 2005



PRINTED NAME OF NOTARY: Sara Abramowitz-Hill

PRINCIPAL PLACE OF BUSINESS: 1250 Addison St. Ste G
ALAMEDA County Berkeley CA 94702

COMMISSION NO. OF NOTARY: 1322717

STATEMENT CONCERNING IMPROVEMENT REQUIREMENTS (§66411.1 DIV. 2 GOVERNMENT CODE)

1. A 6' WIDE STANDARD SIDEWALK SHALL BE CONSTRUCTED ALONG 9TH STREET BY SUBDIVIDER AT SUCH TIME AS THE PARCELS ARE DEVELOPED.
2. THE EXISTING STRUCTURE LOCATED PARTIALLY ON PARCEL A AND PARTIALLY ON PARCEL B SHALL BE DEMOLISHED PRIOR TO SALE OF PARCEL A.

ASHBY LOFTS ASSOCIATES, A LIMITED PARTNERSHIP
1250 ADDISON STREET, SUITE G
BERKELEY, CA 94702

BY: Susan Friedland
SUSAN FRIEDLAND
EXECUTIVE DIRECTOR

SURVEYOR'S STATEMENT:

THIS MAP WAS PREPARED BY ME OR UNDER MY DIRECTION AND IS BASED UPON A FIELD SURVEY IN CONFORMANCE WITH THE REQUIREMENTS OF THE SUBDIVISION MAP ACT AND LOCAL ORDINANCE AT THE REQUEST OF AFFORDABLE HOUSING ASSOCIATES, INC. IN FEBRUARY, 2005. I HEREBY STATE THAT THIS PARCEL MAP SUBSTANTIALLY CONFORMS TO THE APPROVED OR CONDITIONALLY APPROVED TENTATIVE PARCEL MAP, IF ANY, AND THAT ALL MONUMENTS ARE OF THE CHARACTER AND OCCUPY THE POSITION INDICATED AND THAT THE MONUMENTS ARE SUFFICIENT TO ENABLE THE SURVEY TO BE RETRACED.

DATE: 6-20-05

Paul Canumay
PAUL CANUMAY, L.S. 3272
EXPIRATION DATE: 6/30/06

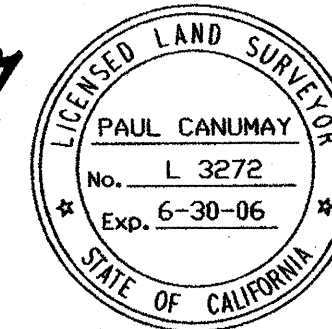

CITY ENGINEER'S STATEMENT:

I HAVE EXAMINED THIS MAP AND THE SUBDIVISION AS SHOWN IS SUBSTANTIALLY THE SAME AS IT APPEARS ON THE TENTATIVE MAP (IF ANY) AND ANY APPROVED ALTERATIONS THEREOF.

THIS PARCEL MAP CONFORMS TO THE REQUIREMENTS OF THE SUBDIVISION MAP ACT AND LOCAL ORDINANCES.

I AM SATISFIED THAT THIS MAP IS TECHNICALLY CORRECT.

DATE: 7/1/05

Jeffrey E. Berg
JEFFREY E. BERG, E.C.E. 23818
MANAGER OF ENGINEERING
EXPIRATION DATE: DECEMBER 31, 2005

PLANNING DIRECTOR'S STATEMENT:

THIS MAP HAS BEEN APPROVED BY THE PLANNING DIRECTOR, CITY OF BERKELEY ON August 26, 2005, AND WHEN RECORDED BECOMES THE OFFICIAL MAP OF THIS LAND DIVISION.

Dan Marks
DAN MARKS, PLANNING DIRECTOR
PLANNING DEPARTMENT

CLERK OF THE BOARD OF SUPERVISOR'S STATEMENT:

I, CRYSTAL K. HISHIDA, CLERK OF THE BOARD OF SUPERVISORS OF THE COUNTY OF ALAMEDA, STATE OF CALIFORNIA, DO HEREBY STATE THAT CERTIFICATES HAVE BEEN FILED AND DEPOSITS HAVE BEEN MADE IN CONFORMANCE WITH THE REQUIREMENTS OF SECTION 66492 AND 66493 OF THE GOVERNMENT CODE OF THE STATE OF CALIFORNIA.

DATE: 10/27/05

CRYSTAL K. HISHIDA, CLERK OF THE BOARD OF SUPERVISORS OF THE COUNTY OF ALAMEDA, STATE OF CALIFORNIA

BY: [Signature]
DEPUTY

RECORDER'S STATEMENT:

FILED THIS 10th DAY OF NOVEMBER, 2005, AT 9:30 A.M. IN BOOK 284 OF PARCEL MAPS, AT PAGES 91-93, AT THE REQUEST OF Old Republic
FEE 12- SERIES NO. 2005485139



PATRICK O'CONNELL
COUNTY RECORDER

BY: C. Valdez-Walsh
DEPUTY COUNTY RECORDER

PARCEL MAP NO. 8179

BEING A RESUBDIVISION OF A PORTION OF LOTS 330 TO 344, INCLUSIVE, MAP OF THE POTTER TRACT FILED 6/03/1892 BOOK 17 OF MAPS, PAGE 19, ALAMEDA COUNTY RECORDS
BERKELEY, ALAMEDA COUNTY, CALIFORNIA

JUNE 20, 2005



SHEET 1 OF 3 SHEETS

HOME \ SURVEY \ AFFORDABLE HOUSING ASSOCIATES \ PM 8179.dwg