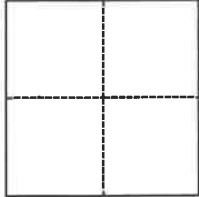

CORNER RECORD

Agency Index

BK 148 PG 86

Document Number CR 15435

City of Oakland (APN 15-1380-21) County of Alameda, CaliforniaBrief Legal Description City monument at Telegraph Avenue and 62nd Street, near 6211 Telegraph Ave.**CORNER TYPE**

- ☐ Government Corner ☒ Control
☐ Meander ☐ Property
☐ Rancho ☐ Other

Date of Survey July 1, 2021**COORDINATES (Optional)**N. E. Elevation Units ☐ Metric ☒ U.S. Survey FootHorizontal Datum Zone Epoch Date Vertical Datum ☐ Complies with Public Resources Code §§8801-8819☐ Complies with Public Resources Code §§8890-8902PLS Act Ref.: ☐ 8765(d) ☒ 8771 ☐ 8773 ☐ Other:

Corner/
Monument: ☒ Left as found ☐ Established ☐ Rebuilt ☒ Pre-Construction
☐ Found and tagged ☐ Reestablished ☒ Referenced ☐ Post-Construction

Narrative of corner identified and monument as found, set, reset, replaced, or removed:

☒ See sheet #2 for description(s):

Found monument that could be damaged or destroyed by planned water line construction project. Monument was referenced as shown on page 2. The purpose of this Corner Record is to preserve possible evidence only; no attempt was made to determine the relationship to property, centerline, or right of way lines.

Reference EBMUD CR Book C, Page 33 (Clarke/Chou)

SURVEYOR'S STATEMENT

This Corner Record was prepared by me or under my direction in conformance with

the Professional Land Surveyors' Act on August 24, 2021Signed  P.L.S. or R.C.E. No. 8889**COUNTY SURVEYOR'S STATEMENT**This Corner Record was received and examined and filed SEP 02 2021Signed  P.L.S. or R.C.E. No. 7010Title ALAMEDA COUNTY SURVEYOR

County Surveyor's Comment



OAKLAND

ALAMEDA COUNTY

TRACT 4248
136 M 41
1

6211 TELEGRAPH AVENUE
APN 15-1380-21

RESUB
PORTION
ROBERTS &
WOLFSKILL
TRACT
10 M 55
BLOCK H

AVENUE

STREET

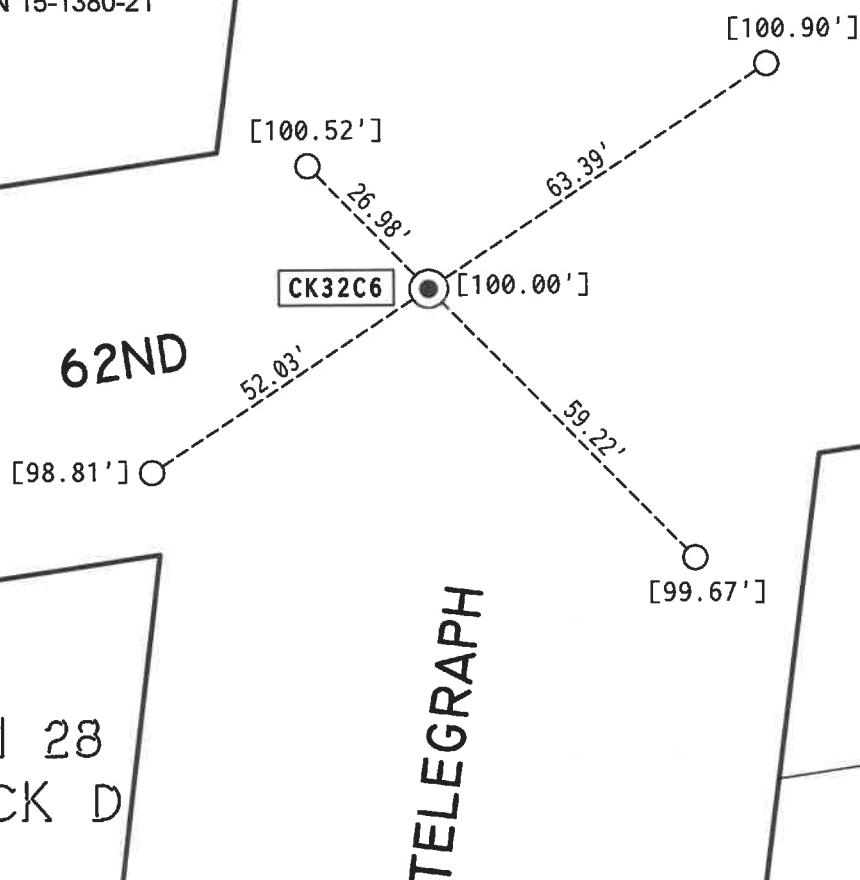

9 M 28
BLOCK D

MAP NO. 3
ROBERTS &
WOLFSKILL
TRACT
9 M 5
BLOCK K

LEGEND

FOUND CITY OF OAKLAND "5 NW 6", A 1/4" NAIL IN CONCRETE, DOWN 0.5' IN STANDARD MONUMENT WELL



SET CONCRETE ANCHOR NAIL AND 1-1/2" ALUMINUM WASHER, STAMPED "EBMUD MON RP"



ASSUMED ELEVATION (MEASURED USING A LEICA DIGITAL LEVEL)

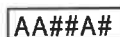

ALAMEDA COUNTY MONUMENT I.D.

SCALE
1"=30'



ADDRESS: 6211 TELEGRAPH AVENUE

APN: 15-1380-21