

EXHAUST FAN INFORMATION – JOB#4510360

FAN UNIT NO	TAG	QTY	FAN UNIT MODEL #	CFM	ESP	RPM	MOTOR ENCL	HP	BHP	Ø	VOLT	FLA	DISCHARGE VELOCITY	WEIGHT (LBS)	SDNES
1		1	EABDU18	3100	1.250	1171	DDP	2.000	1.2290	3	208	5.9	716 FPM	184	14.6
2		1	EABDU18	3100	1.250	1171	DDP	2.000	1.2290	3	208	5.9	716 FPM	184	14.6
3		1	EABDCR7	450	0.250	1128	DDP	0.250	0.0850	1	115	4.8		90	6.3

CONDENSER DETAILS

FAN UNIT NO	TAG	FAN UNIT MODEL #	CONDENSER NO	TONNAGE	VOLTAGE	PHASE	FREQUENCY	MCA	RLA	MAX FUSE SIZE	MIN WIRE SIZE	SEER
4		EA3-D.500-G18-MPU	1	5	208-230	3 PHASE	60 HZ	21.4 AMPS	17.4 AMPS	30 AMPS	10 AWG	14
			2	5	208-230	3 PHASE	60 HZ	21.4 AMPS	17.4 AMPS	30 AMPS	10 AWG	14

MUA FAN INFORMATION – JOB#4510360

FAN UNIT NO	TAG	QTY	FAN UNIT MODEL #	BLOWER	HOUSING	MIN CFM	DESIGN CFM	ESP	RPM	MOTOR ENCL	HP	BHP	Ø	VOLT	FLA	MCA	MDCP	COOLING COIL ENTERING DB TEMP	COOLING COIL ENTERING WB TEMP	COOLING COIL LEAVING DB TEMP	COOLING COIL LEAVING WB TEMP	COOLING COIL TOTAL CAPACITY	COOLING COIL SENSIBLE CAPACITY	COOLING COIL LATENT CAPACITY	WEIGHT (LBS)	SDNES
4		1	EA3-D.500-G18-MPU	G18-PB	A3-D.500	3500	4956	0.750	864	DDP,PREMIUM	5.000	3.0120	3	208	15.0	18.8A	30A	95.0°F	78.0°F	81.8°F	71.9°F	120.0 MBH	68.2 MBH	51.8 MBH	1914	15.9

GAS FIRED MAKE-UP AIR UNIT(S)

FAN UNIT NO	TAG	INPUT BTUs	OUTPUT BTUs	TEMP RISE	REQUIRED INPUT GAS PRESSURE	GAS TYPE	BURNER EFFICIENCY(%)
4		308938	284223	54°F	7 IN. W.C. – 14 IN. W.C.	NATURAL	92

FAN OPTIONS

FAN UNIT NO	TAG	QTY	DESCRIPTION
1		1	GREASE BOX.
		1	UPBLAST FAN WHEEL ACCESS PORT.
2		1	GREASE BOX.
		1	UPBLAST FAN WHEEL ACCESS PORT.
3		1	I 15-BDD DAMPER.
4		1	AC INTERLOCK RELAY – 24VAC COIL.
		1	LDW FIRE START.
		1	INLET PRESSURE GAUGE, 0–35".
		1	MANIFOLD PRESSURE GAUGE, –5 TO 15" WC.
		1	MOTORIZED BACKDRAFT DAMPER FOR A3-D HOUSING.
		1	COOLING THERMOSTAT AND RELAY (NOT REQ FOR EVAP).
		1	DOWNTURN PLENUM FOR SIZE 3 DX COIL MODULE.
		1	SHIP CONDENSERS LOOSE. TWO CONDENSERS, THREE PHASE.
		1	FREEZESTAT (10).
		1	10 TON 2 CIRCUIT (5/5) MODULAR PACKAGED COOLING OPTION FOR SIZE 3 DF/EH MUA (3,600 TO 6,000 CFM), 208V/230V, 3 PHASE. COOLING THERMOSTAT OR PROGRAMMABLE STAT REQUIRED FOR PROPER OPERATION.
		1	SEPARATE 120V WIRING PACKAGE (REQUIRED AND USED ONLY FOR DCV OR PREWIRE WITH VFD) – THREE PHASE ONLY.

FAN ACCESSORIES

FAN UNIT NO	TAG	EXHAUST				SUPPLY			
		GREASE CUP	GRAVITY DAMPER	WALL MOUNT	SIDE DISCHARGE	GRAVITY DAMPER	MOTORIZED DAMPER	WALL MOUNT	
1		YES							
2		YES							
3			YES						
4							YES		

CURB ASSEMBLIES

NO	ON FAN	WEIGHT	ITEM	SIZE	
1	# 1	38 LBS	CURB	26.500"W X 26.500"L X 24.000"H	VENTED HINGED.
2	# 2	38 LBS	CURB	26.500"W X 26.500"L X 24.000"H	VENTED HINGED.
3	# 3	18 LBS	CURB	19.500"W X 19.500"L X 12.000"H	
4	# 4	114 LBS	CURB	35.000"W X 84.000"L X 20.000"H	INSULATED.
	# 4		RAIL	6.000"W X 35.000"L X 20.000"H	

NOTE: UNLESS OTHERWISE STATED, PANDA RESTAURANT GROUP SHALL PROVIDE ALL EQUIPMENT ON THE FOLLOWING CAPTIVEAIRE SHEETS, INCLUDING: HOODS, FIRE SYSTEM, EXHAUST FANS, SUPPLY FAN, BATHTROOM FAN AND ELECTRICAL INTERLOCK PACKAGE.

ANSUL GAS VALVE:

THE ANSUL GAS VALVE IS PROVIDED BY CAPTIVEAIRE SYSTEMS. CONTACT OUR OFFICE WITH THE VALVE SIZE 3 DAYS IN ADVANCE OF WHEN IT IS NEEDED ON SITE.

FOR QUESTIONS CALL THE CAPTIVEAIRE SOUTHERN CALIFORNIA OFFICE

3002 DOW AVENUE, SUITE 410  
TUSTIN, CA 92780  
TEL: 714-957-1500 EMAIL: REG66@CAPTIVEAIRE.COM

FANS #1, #2 – EABDU18 EXHAUST FAN

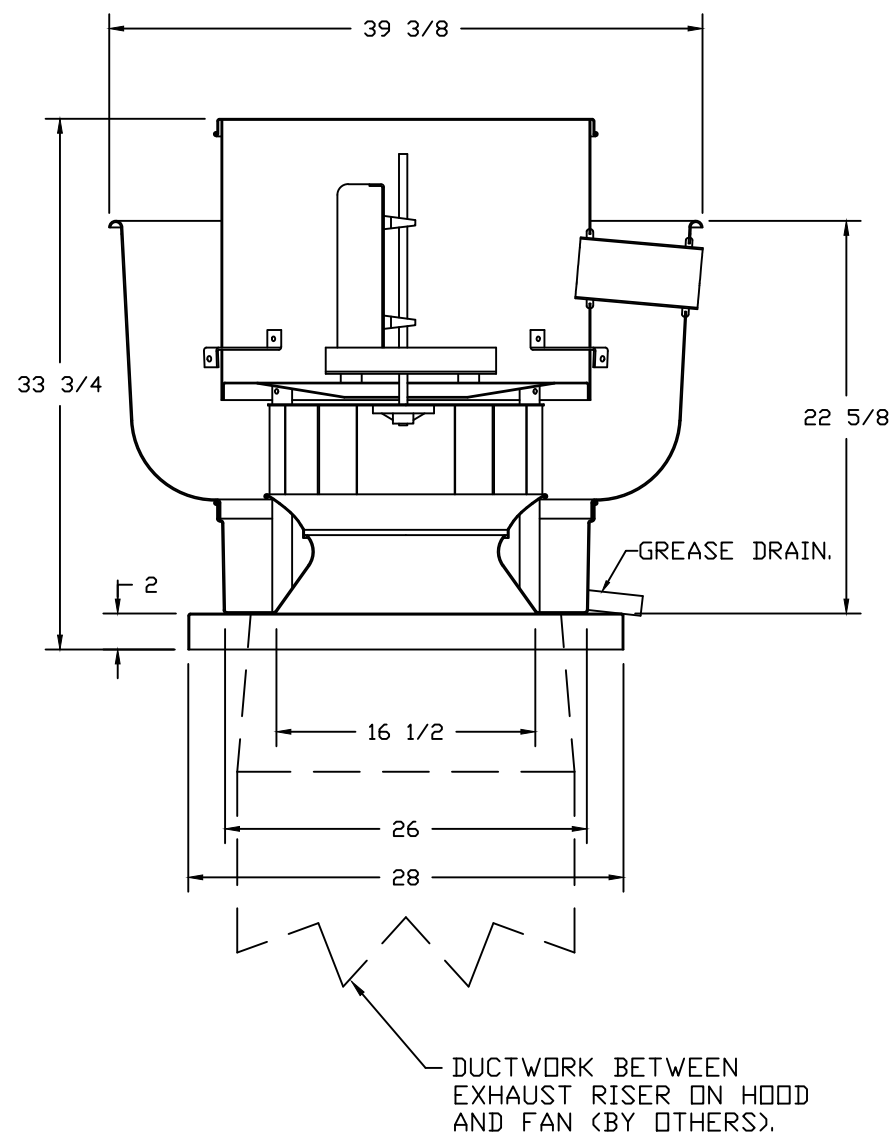

FAN #3 EABDCR7 – EXHAUST FAN

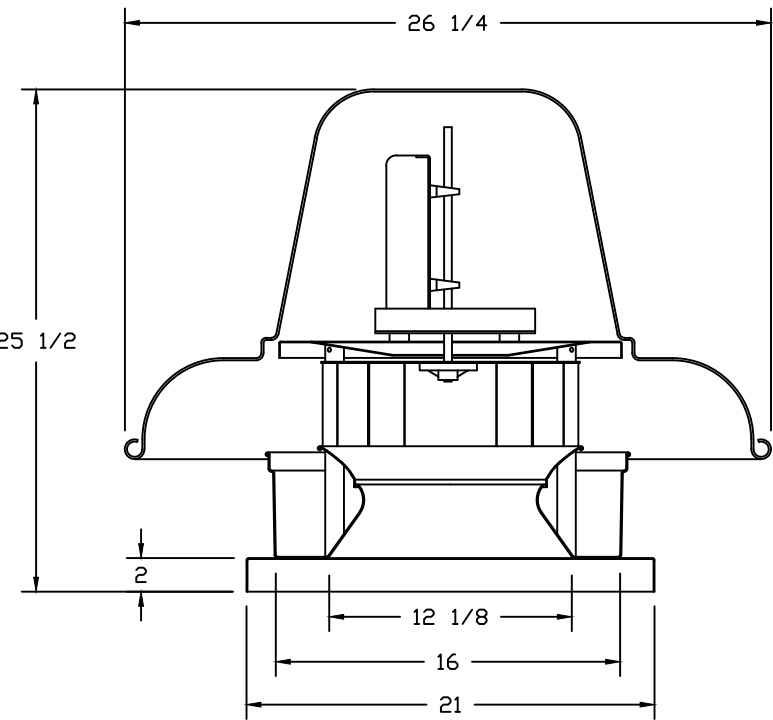

FEATURES:

- ROOF MOUNTED FANS.
- RESTAURANT MODEL.
- UL705 AND UL762 AND ULC-S645.
- AMCA SOUND AND AIR CERTIFIED.
- WIRING FROM MOTOR TO DISCONNECT SWITCH.
- WEATHERPROOF DISCONNECT.
- HIGH HEAT OPERATION 300°F (149°C).
- GREASE CLASSIFICATION TESTING.

NORMAL TEMPERATURE TEST  
EXHAUST FAN MUST OPERATE CONTINUOUSLY WHILE EXHAUSTING AIR AT 300°F (149°C) UNTIL ALL FAN PARTS HAVE REACHED THERMAL EQUILIBRIUM, AND WITHOUT ANY DETERIORATING EFFECTS TO THE FAN WHICH WOULD CAUSE UNSAFE OPERATION.

ABNORMAL FLARE-UP TEST  
EXHAUST FAN MUST OPERATE CONTINUOUSLY WHILE EXHAUSTING BURNING GREASE VAPORS AT 600°F (316°C) FOR A PERIOD OF 15 MINUTES WITHOUT THE FAN BECOMING DAMAGED TO ANY EXTENT THAT COULD CAUSE AN UNSAFE CONDITION.

OPTIONS

- GREASE BOX.
- UPBLAST FAN WHEEL ACCESS PORT.

FEATURES:

- ROOF MOUNTED FANS.
- UL705.
- AMCA SOUND AND AIR CERTIFIED.
- WIRING FROM MOTOR TO DISCONNECT SWITCH.
- DISCONNECT SWITCH.
- STANDARD BIRD SCREEN.

OPTIONS

- I 15-BDD DAMPER.

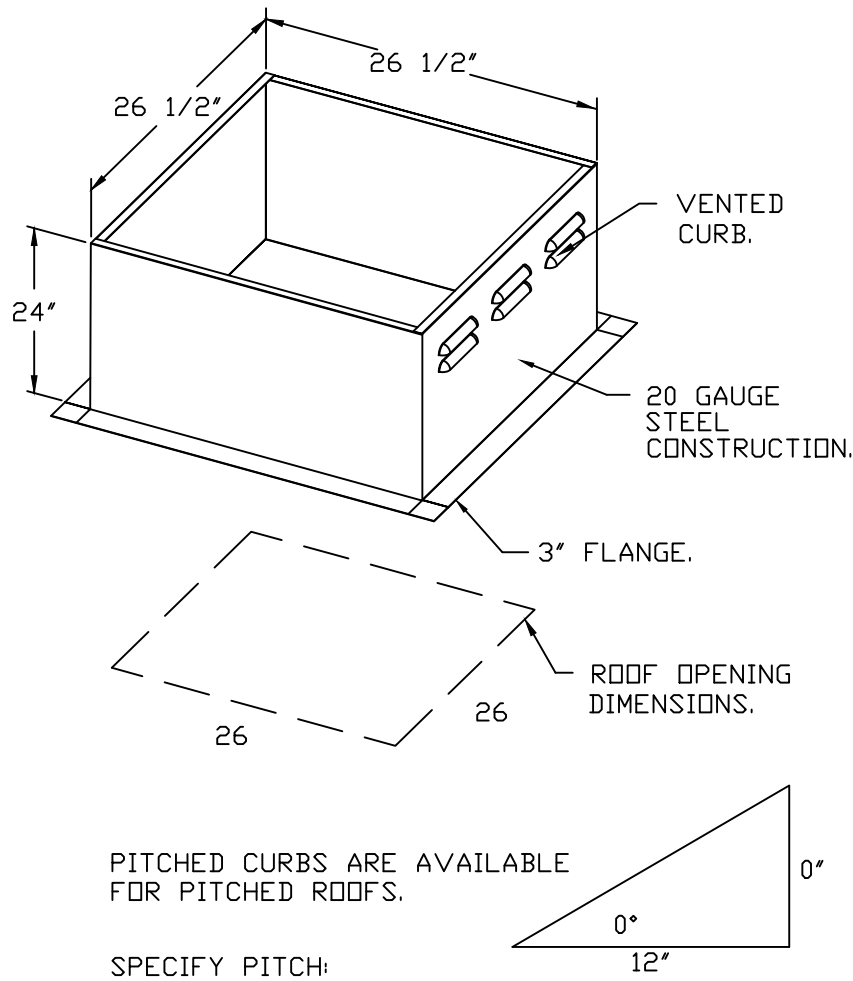

PITCHED CURBS ARE AVAILABLE FOR PITCHED ROOFS.

SPECIFY PITCH:  
EXAMPLE: 7/12 PITCH = 30° SLOPE.

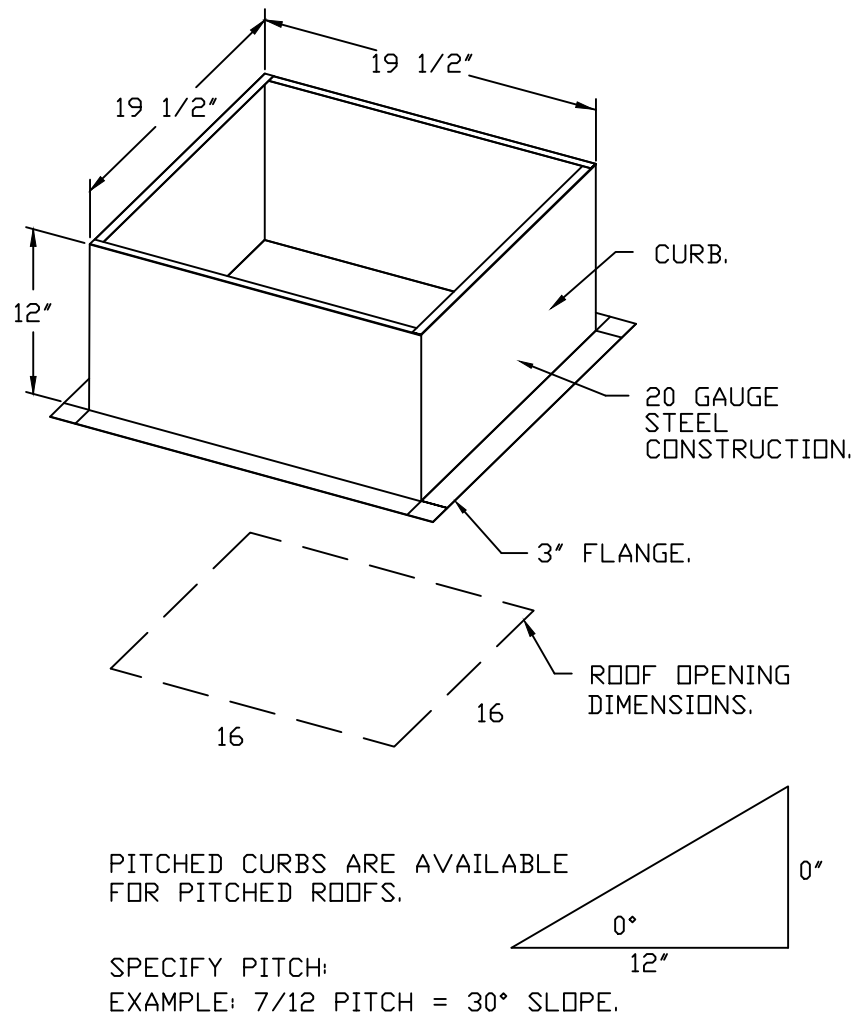

PITCHED CURBS ARE AVAILABLE FOR PITCHED ROOFS.

SPECIFY PITCH:  
EXAMPLE: 7/12 PITCH = 30° SLOPE.

BACKDRAFT DAMPER INSTALLATION

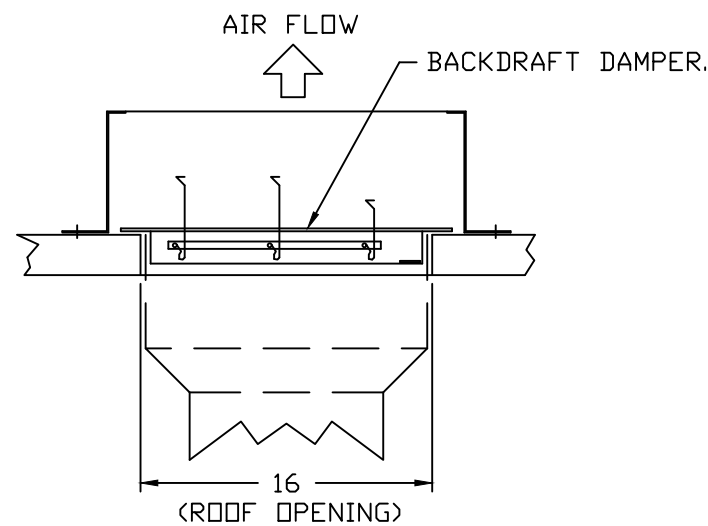

REVISIONS	
DESCRIPTION	DATE
Δ	
Δ	
Δ	
Δ	



3002 Dow Ave., Suite 410, Tustin, CA 92780 PHONE: (714) 957-1500 FAX: (919) 227-5975 EMAIL: reg66@captivaire.com

Southern California Office

Panda Express – Richmond VA (D7864)  
RICHMOND, VA, 23223

DATE: 9/4/2020

DWG.#:  
4510360

DRAWN BY: AH-86

SCALE:  
3/4" = 1'-0"

MASTER DRAWING

SHEET NO.  
3



PANDA RESTAURANT GROUP INC.

1683 Walnut Grove Ave.  
Rosemead, California  
91770

Telephone: 626.799.9898  
Facsimile: 626.372.8288

All ideas, designs, arrangement and plans indicated or represented by this drawing are the property of Panda Express Inc. and were created for use on this specific project. None of these ideas, designs, arrangements or plans may be used by or disclosed to any person, firm, or corporation without the written permission of Panda Express Inc.

REVISIONS:

ISSUE DATE:

1	CHECK SET	10-23-20
2	PERMIT SET	03-15-21
3	BID SET	04-02-21

DRAWN BY:

PANDA PROJECT #: S4-21-D7864

ARCH PROJECT #: P7350



PANDA EXPRESS

END CAP - TENANT BUILD OUT  
4501 S LABURNUM AVE  
RICHMOND VA, 23231

M-402

HOOD DETAIL PLAN